

For Lease
8,700 SF
Industrial Space



8807 Castner

El Paso, Texas

Property Features

- Premises - 8,400 Square Feet
- Office - 480 Square Feet
- Clear Height - 20'
- 1 Standard Dock High Door
- 1 Ramp Dock
- Evaporative Cooling in Warehouse
- A/C in Office
- Gas Heat

Great Warehouse space in the Heart of East El Paso. It is convenient to Interstate 10 and the Zaragoza Port. 8,400 SF ready for occupancy with Dock High and Ramp access.



For more information:

Doug Derrick

+1 915 727 4000 • dderrick@naielpaso.com

NO WARRANTY OR REPRESENTATION, EXPRESS OR IMPLIED, IS MADE AS TO THE ACCURACY OF THE INFORMATION CONTAINED HEREIN, AND THE SAME IS SUBMITTED SUBJECT TO ERRORS, OMISSIONS, CHANGE OF PRICE, RENTAL OR OTHER CONDITIONS, PRIOR SALE, LEASE OR FINANCING, OR WITHDRAWAL WITHOUT NOTICE, AND OF ANY SPECIAL LISTING CONDITIONS IMPOSED BY OUR PRINCIPALS NO WARRANTIES OR REPRESENTATIONS ARE MADE AS TO THE CONDITION OF THE PROPERTY OR ANY HAZARDS CONTAINED THEREIN ARE ANY TO BE IMPLIED.

For Lease
8,700 SF
Industrial Space

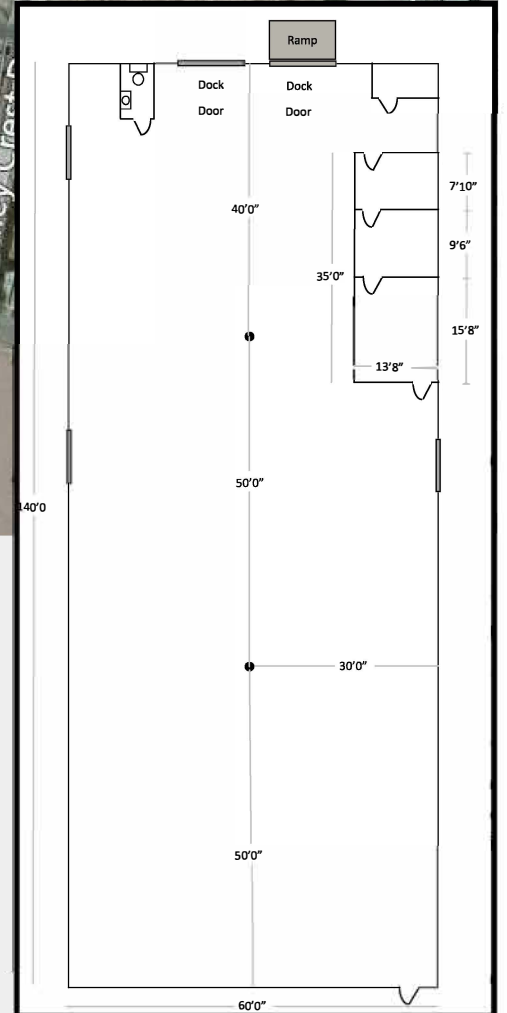
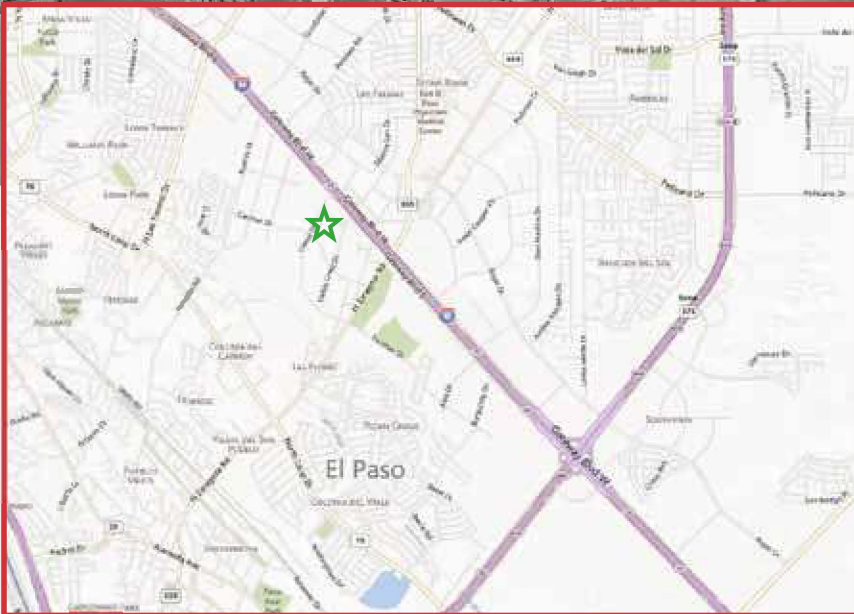

For more information:

Doug Derrick

+1 915 727 4000 • dderrick@naielpaso.com

NAI El Paso
Commercial Real Estate Services, Worldwide.

4901 N Mesa St, Ste. 3B

El Paso, TX 79912

+1 915 859 3017

naielpaso.com